

FUSE LINKS FOR HIGH POWER SAFETY DEVICE



The series fuse links for high power safety devices is designed for short circuit protection. They are distinguished with high speed of operation and high reliability. The element is a ceramic (porcelain) body filled with fine quartz sand for voltaic arc lowering. In the ceramic body is mounted a fusible, specially profiled wafer connecting the current leading terminals. These terminals are manufactured of copper alloy with special nickel coating and have the form of knives to provide more contact surface. The fuse links correspond to “gL – gG” class which means that they are with common function and normal response time.

TWO OPERATING CLASSES OF NH FUSES ARE AVAILABLE:

- Operating class gL/gG – general purpose, line protection, slow acting

Technical data:	
Rated voltage:	500V
Rated short circuit current:	120 kA
IP code:	IP 00
Environmental temperature:	-5° to +65°C
Altitude:	up to 2000m

Dimensions:

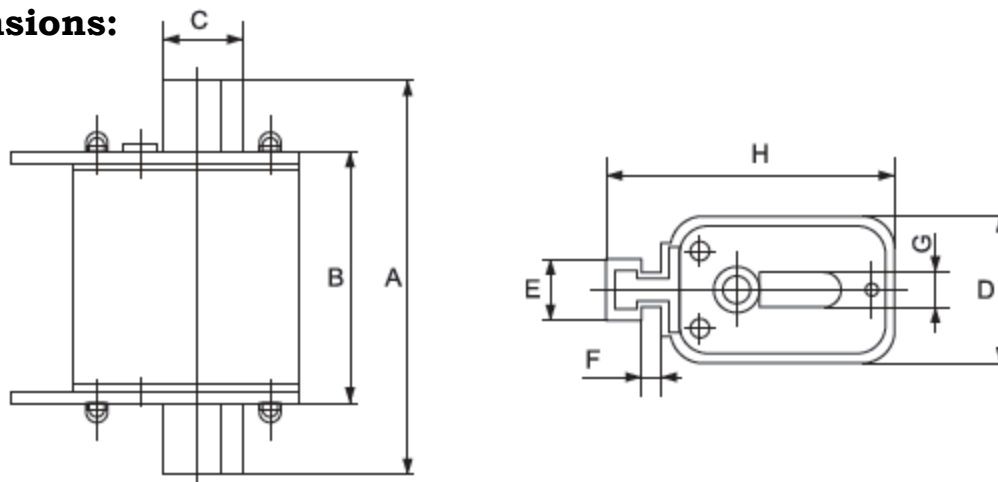

Dimensions
(mm)

Base type	A	B	C	D	H
NT00	78	40	15	29	56.5
NT 0	125	68	15	29	56.5
NT 1	135	68	21	48	62
NT 2	150	68	27	58	72
NT 3	150	68	33	67	84.5
NT00C	78	40	15	21	56.5
NT1C	135	68	21	29	62
NT2C	150	68	33	48	84.5

Basic data:



Type	In (A)	Un (V)	Packing/ Box (pcs)	Catalogue number
<i>NT00</i>	16	500, 600	3/90	10001
<i>NT00</i>	25	500, 600	3/90	10002
<i>NT00</i>	32	500, 600	3/90	10003
<i>NT00</i>	40	500, 600	3/90	10004
<i>NT00</i>	50	500, 600	3/90	10005
<i>NT00</i>	63	500, 600	3/90	10006
<i>NT00</i>	80	500, 600	3/90	10008
<i>NT00</i>	100	500, 600	3/90	10009
<i>NT00</i>	125	500, 600	3/90	10012
<i>NT00</i>	160	500, 600	3/90	10016



Type	In (A)	Un (V)	Packing/ Box (pcs)	Catalogue number
<i>NTO</i>	16	500, 600	3/90	10015
<i>NTO</i>	25	500, 600	3/90	10025
<i>NTO</i>	32	500, 600	3/90	10032
<i>NTO</i>	40	500, 600	3/90	10040
<i>NTO</i>	50	500, 600	3/90	10050
<i>NTO</i>	63	500, 600	3/90	10063
<i>NTO</i>	80	500, 600	3/90	10080
<i>NTO</i>	100	500, 600	3/90	10090
<i>NTO</i>	125	500, 600	3/90	10092
<i>NTO</i>	160	500, 600	3/90	10096



Type	In (A)	Un (V)	Packing/ Box (pcs)	Catalogue number
NT1	80	500, 600	3/36	10108
NT1	100	500, 600	3/36	10110
NT1	125	500, 600	3/36	10112
NT1	160	500, 600	3/36	10116
NT1	200	500, 600	3/36	10120
NT1	225	500, 600	3/36	10122
NT1	250	500, 600	3/36	10125



Type	In (A)	Un (V)	Packing/ Box (pcs)	Catalogue number
NT2	160	500, 600	1/24	10216
NT2	200	500, 600	1/24	10220
NT2	250	500, 600	1/24	10225
NT2	315	500, 600	1/24	10231
NT2	400	500, 600	1/24	10240



Type	In (A)	Un (V)	Packing/ Box (pcs)	Catalogue number
NT3	500	500, 600	1/24	10350
NT3	630	500, 600	1/24	10363



Type	In (A)	Un (V)	Packing/ Box (pcs)	Catalogue number
NT00C	16	500, 600	3/120	10001C
NT00C	25	500, 600	3/120	10002C
NT00C	32	500, 600	3/120	10003C
NT00C	40	500, 600	3/120	10004C
NT00C	50	500, 600	3/120	10005C
NT00C	63	500, 600	3/120	10006C
NT00C	80	500, 600	3/120	10008C
NT00C	100	500, 600	3/120	10009C



Type	In (A)	Un (V)	Packing/ Box (pcs)	Catalogue number
<i>NT1C</i>	80	500, 600	3/54	<i>10108C</i>
<i>NT1C</i>	100	500, 600	3/54	<i>10110C</i>
<i>NT1C</i>	125	500, 600	3/54	<i>10112C</i>
<i>NT1C</i>	160	500, 600	3/54	<i>10116C</i>



Type	In (A)	Un (V)	Packing/ Box (pcs)	Catalogue number
<i>NT2C</i>	160	500, 600	1/30	<i>10216C</i>
<i>NT2C</i>	200	500, 600	1/30	<i>10220C</i>
<i>NT2C</i>	250	500, 600	1/30	<i>10225C</i>

Standards:

- EN 60269-1
- EN 60269-2

